

# MATH 1322 Precalculus I

Fall 2013

Section 005: 104 University Hall, 9:30-10:50 AM, TuTh

**Instructor:** Hongguang Xi

**Office:** 427 Pickard Hall

**Office Telephone:** 817-272-5681

**Email Address:** hongguang.xi@mavs.uta.edu

**Office Hours:** 11:00-12:00 AM, TuTh; or by appointment.

**From the undergraduate catalog:** E-mail is a prime means for communication. Therefore, the University has the right to send communications to students via e-mail and the right to expect that those communications will be received and read in a timely fashion. The Office of Information Technology (OIT) will assign all students an official University e-mail address. **It is to this official address that the University will send e-mail communications. Students are expected to check their official e-mail account on a frequent and consistent basis to stay current with University communications. The University recommends checking e-mail daily in recognition that certain communications may be time-critical.**

**Textbook:** *Precalculus* by Lial, Hornsby, Schneider and Daniels.

**Course Prerequisites:** A sufficient score on the Math Aptitude Test or sufficient SAT/ACT math scores.

**Learning outcomes:** Upon completion of Math 1322:

1. Students will be able to solve problems by applying elementary algebra: properties of the real number system and complex number system, using rules for exponents and radicals, simplifying algebraic expressions, solving equations and inequalities.
2. Students will be able to graph polynomial equations of first and second degree and to explain features of the graphs such as: intercepts, vertex, slope, line of symmetry and translations.
3. Students will be able to define a function and determine if an equation represents a function. They will be able to perform operations on functions such as: addition, multiplication, division, composition and finding inverse functions. Students will be able to define and find the domain and range of a function.
4. Students will be able to sketch the graph of polynomial and rational functions, without the aid of a graphing calculator, including finding complex zeros and identifying asymptotes of rational functions.
5. Students will be able to identify and solve problems involving exponential and logarithmic functions and equations.

6. Students will be able to solve problems involving systems of two equations in two unknowns, using the method of substitutions or the theorem of equivalent systems.

**Grading Scale:** A: 90-100 B: 80-89 C: 70-79 D: 60-69 F: 0-59

**Grade components:**

1. Midterm 1 — 20%, Friday, September 20, 2013; 6:00pm - 8:00pm
2. Midterm 2 — 25%, Friday, October 25, 2013; 6:00pm - 8:00pm
3. Final examination — 35%, Saturday, December 7, 2013; 12:30pm - 3:00pm
4. Quizzes — 20%. Each quiz will be given on Thursday, around 15 minutes before the end of the class. Calculators TI-30XA or TI-30XIIS can be used for quizzes.
5. MyMathLab — This is just for practice and it won't be a graded component. Students with access code can register at <http://www.mymathlab.com> using UTA email, then get enrolled in my online course by selecting my Course ID: xi79605.

**Midterms and Finals:** These exams are departmental, i.e., all sections of Math 1322 will take the same exam and the grades will have the same weight in each section. All of these exams are comprehensive. Each exam will be a mix of multiple choice problems and show-your-work problems.

**Any student who scores below 50 on the final exam cannot receive a grade higher than D in the course.**

**Make-up Policy:** No make-up exams or quizzes. If your class schedule has a conflict with either midterm or final, you must complete a makeup request form and provide sufficient documentation of your conflict to the instructor by Census Date (September 9). Delays in submitting a make-up request may mean that your request cannot be approved.

**Note:** Two lowest quizzes won't be used to compute your course grade.

**Attendance Policy:** Attendance to all seminars, lab days and critiques is required. Absences are only excused for participation in University-sanctioned events, significant and verifiable issues, or the observance of religious holidays. In the case of extended illness or injury, the doctor's notes will give justification for a possible grade of "incomplete". More than four unexcused absences will lower your final grade 10%.

**Drop Policy:** Students may drop or swap (adding and dropping a class concurrently) classes through self-service in MyMav from the beginning of the registration period through the late registration period. After the late registration period, students must see their academic advisor to drop a class or withdraw. **Students must consult with their major advisor to drop a course.** Drops can continue through a point two-thirds of the way through the term or session. Any student

who drops the course on or before Wednesday, October 30 at 5:00 PM will receive a W. It is the student's responsibility to officially withdraw if they do not plan to attend after registering. **Students will not be automatically dropped for non-attendance.** Repayment of certain types of financial aid administered through the University may be required as the result of dropping classes or withdrawing. For more information, contact the Office of Financial Aid and Scholarships (<http://wweb.uta.edu/aao/fao/>).

**Calculators: The only calculators allowed for the midterms and final are TI-30XA and TI-30XIIS.**

**If you wish to use a different calculator, then you must get permission to do so BEFORE an exam.** Only nonprogrammable calculators with basic computational features, such as arithmetic and transcendental functions will be allowed. Calculators with the following features are **NOT** allowed: graphing, equation solving, differentiation and integration. Any device that has internet or e-mail capabilities this — **this means NO cell phones** — and any device with a **QWERTY** keyboard are also not permitted.

**Student Support Services Available:** The University of Texas at Arlington provides a variety of resources and programs designed to help students develop academic skills, deal with personal situations, and better understand concepts and information related to their courses. These resources include tutoring, major-based learning centers, developmental education, advising and mentoring, personal counseling, and federally funded programs. For individualized referrals to resources for any reason, students may contact the Maverick Resource Hotline at 817-272-6107 or visit [www.uta.edu/resources](http://www.uta.edu/resources) for more information.

**Supplemental Instruction (SI)** is a FREE voluntary academic development program that increases student performance and retention. The program is offered to all students in this class, as well as for other historically difficult subjects on campus.

SI provides regularly scheduled out-of-class peer facilitated sessions. A senior student (SI Leader), **Alex Skelton**, who has successfully taken the course before, facilitates structured group study sessions to support students to master course content and learn effective study skills.

On average, students who attend SI on a regular basis, obtain a half letter to a full letter grade higher when compared to those students who do not attend. It is also a great way to get to know students in your class.

All SI Leaders receive extensive training. Session times will be presented by your SI Leader during the first week of class; alternatively you can visit our website at <http://www.uta.edu/utsi>.

The Math Department operates the **Math Clinic**, a tutoring service staffed by upper level undergraduate students. When you registered for this course, you were assessed a fee which allows you unlimited access to the Math Clinic. You will need to show your Mav ID to use the Math Clinic. The Math Clinic is in room 314 PKH; the phone number is 817-272-5674; and the hours of operation for fall and spring are

Go to the Math Clinic webpage <http://www.uta.edu/math/clinic/> to get more information or to access assignment sheets for the courses for which tutoring is offered.

Monday — Thursday	8am-8pm
Friday	8am-1pm
Saturday	10am-6pm
Sunday	1pm-9pm

The **SOAR program** is an academic support program that provides tutoring, counseling, seminars, graduate school preparation, course reviews, study groups and other support services by trained staff dedicated to helping UT Arlington students reach their full academic potential. Go to <http://www.uta.edu/soar/> for more details.

All previous midterm exams and some previous final exams are available to students in the **Science Education and Career Center (SECC)**, 106 Life Science Building. The fall and spring hours of operation are

Monday — Thursday	8am-8pm
Friday	8am-5pm
Saturday	12pm-5pm
Sunday	Closed

You need a Mav ID Card to check out these exams. A copy machine is available for you to make copies. There are also video tapes of lectures on calculus topics that can be viewed in the SECC. For more information, go to <https://www.uta.edu/cos/SECC/login.php>.

**University Tutoring:** University Tutoring is a tutoring program available to all UT Arlington students. Students pay \$6.50 for a one-hour tutoring session.

**Americans with Disabilities Act:** The University of Texas at Arlington is on record as being committed to both the spirit and letter of federal equal opportunity legislation; reference Public Law 93112 - The Rehabilitation Act of 1973 as amended. With the passage of new federal legislation entitled Americans with Disabilities Act (ADA), pursuant to section 504 of the Rehabilitation Act, there is renewed focus on providing this population with the same opportunities enjoyed by all citizens. As a faculty member, I am required by law to **provide “reasonable accommodation”** to students with disabilities, so as not to discriminate on the basis of that disability. Student responsibility primarily rests **with informing faculty at the beginning of the semester and in providing authorized documentation through designated administrative channels.**

If you require an accommodation based on disability, I would like to meet with you in the privacy of my office, during the first week of the semester, to make sure you are appropriately accommodated.

**Academic Dishonesty:** It is the philosophy of The University of Texas at Arlington that academic dishonesty is a completely unacceptable mode of conduct and will not be tolerated in any form. All persons involved in academic dishonesty will be disciplined in accordance with University regulations and procedures. Discipline may include suspension or expulsion from the University.

“Scholastic dishonesty includes but is not limited to cheating, plagiarism, collusion, the submission for credit of any work or materials that are attributable in whole or in part to another person, taking an examination for another person, any act designed to give unfair advantage to a student or the attempt to commit such acts.” (Regents Rules and regulations, Part One, Chapter IV, Section 3, Subsection 3.2, Subdivision 3.22)

**Grade Replacement and Grade Exclusion Policies:** These policies are described in detail in the University catalog and can also be founded online at [http://web.uta.edu/catalog/content/general/academic\\_regulations.aspx#10](http://web.uta.edu/catalog/content/general/academic_regulations.aspx#10) (scroll about half way down the page).

**Student Disruption:** The University reserves the right to impose disciplinary action for an infraction of University policies. For example, engagement in conduct, alone or with others, intended to obstruct, disrupt, or interfere with, or which in fact obstructs, disrupts, or interferes with, any function or activity sponsored, authorized by or participated in by the University.

**Drop for Non-Payment of Tuition:** If you are dropped from this class for non-payment of tuition, you may secure an Enrollment Loan through the Bursar’s Office.

**Student Feedback Survey:** At the end of each term, students enrolled in classes categorized as “lecture”, “seminar”, or “laboratory” shall be directed to complete an online Student Feedback Survey (SFS). Instructions on how to access the SFS for this course will be sent directly to each student through MavMail approximately 10 days before the end of the term. Each student’s feedback enters the SFS database anonymously and is aggregated with that of other students enrolled in the course. UT Arlington’s effort to solicit, gather, tabulate, and publish student feedback is required by state law; students are strongly urged to participate. For more information, visit <http://www.uta.edu/sfs>.

**Final Review Week:** A period of five class days prior to the first day of final examinations in the long sessions shall be designated as Final Review Week. The purpose of this week is to allow students sufficient time to prepare for final examinations. During this week, there shall be no scheduled activities such as required field trips or performances; and no instructor shall assign any themes, research problems or exercises of similar scope that have a completion date during or following this week unless specified in the class syllabus. During Final Review Week, an instructor shall not give any examinations constituting 10% or more of the final grade, except makeup tests and laboratory examinations. In addition, no instructor shall give any portion of the final examination during Final Review Week. During this week, classes are held as scheduled. In addition, instructors are not required to limit content to topics that have been previously covered; they may introduce

new concepts as appropriate.

**Emergency Exit Procedures:** Should we experience an emergency event that requires us to vacate the building, students should exit the room and move toward the nearest exit (see Fig. 1). When exiting the building during an emergency, one should never take an elevator but should use the stairwells. Faculty members and instructional staff will assist students in selecting the safest route for evacuation and will make arrangements to assist handicapped individuals.

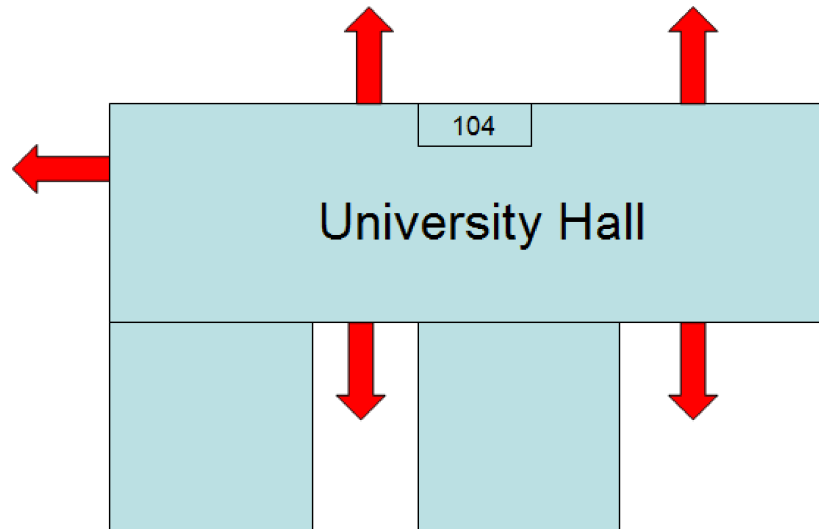

Figure 1: The exit map of the University Hall (UH). Five exits are shown in red arrows. In emergency events students should select the exit nearest to room 104.

**Important Dates:**

- August 22 ..... First Day of Class
- September 9 ..... Census Date
- (Deadline for makeup requests for ALL exams)**
- Friday, September 20 ..... Midterm 1, 6:00-8:00 pm
- Friday, October 25 ..... Midterm 2, 6:00-8:00 pm
- Wednesday, October 30 ..... Last day to drop a class
- November 28, 29 ..... Thanksgiving Holidays
- December 4 ..... Last Day of Class
- Saturday, December 7 ..... Final Exam, 12:30-3:00 pm